

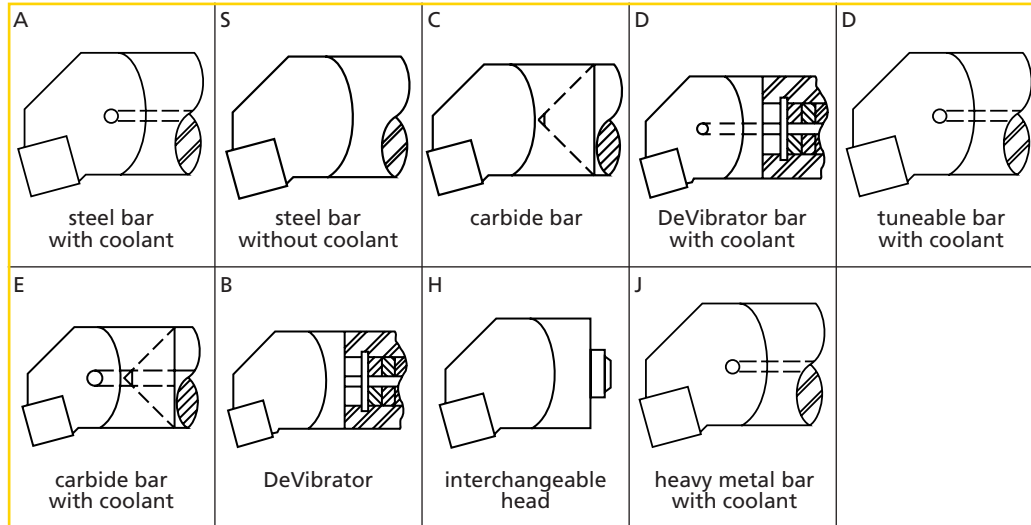

KENLOC
KENDEX TURNING INSERTS
SCREW-ON
TOOLHOLDERS
BORING BARS
TURNING HOLDERS
BORING HEADS
CARTRIDGES



1. Bar Type

Example:

A

2. Bar Diameter

32

3. Bar Length**

- 3 - F
- 3.5 - G
- 4 - H
- 4.5 - J
- 5 - K
- 5.5 - L
- 6 - M
- 6.5 - N
- 6.75 - P
- 7 - Q
- 8 - R
- 10 - S
- 12 - T
- 14 - U
- 16 - V
- 18 - W
- 20 - Y

** Used only when more than one length is available or a special length is required.

Inch:
A two-digit number which indicates the bar diameter in 1/16-inch increments.

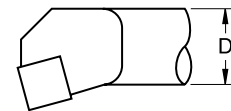



TURNING INSERTS
 KENDEX
 SCREW-ON
 TOOLHOLDERS
 BORING BARS
 BORING HEADS
 CARTRIDGES

C 	D 	K/N
L 	R 	S
T 	V 	W

5. Insert Shape

N 	D
B 	E
C 	F
P 	

7. Insert Clearance Angle



8. Hand of Tool

Insert IC
Number of 1/8ths of "D"

9. Insert Size

M

S

K

N

R

4

D

4. Insert Holding Method

6. Bar Style or Lead Angle

10. Additional Information

C 	M
S 	D*
N* 	

*Kennametal standard only

E 	F 	K
L 	L (E-style Insert) 	P
Q 	S 	U
X 		

M.. TNT/MTS clamping system for ceramic and PCBN inserts
 D dual pocket
 AP5 axial positive
 KC KENCLAMP
 + insert thickness